

BRILLIANT

BUSINESS PARK

MANAGED BY  ALPHA

THE ULTIMATE HUB FOR NEXT-GEN ENTREPRENEURS

THE PINNACLE OF PERFECTION

READY TO DRIVE YOUR BUSINESS
FROM DAY ONE.

The partnership between BRITANIA and ALPHA has established a new standard in real estate development, delivering "INSTITUTIONAL GRADE TRUST" the highest level of institutional reliability. This shared vision creates a solid foundation to elevate confidence and empower investors and business owners alike. We are committed to providing a seamless and precise business ownership experience in every dimension through our comprehensive TURNKEY SOLUTION. Every step is strictly managed and quality-controlled by a team of experts, along with a long-term structural warranty that exceeds market standards for your ultimate peace of mind.

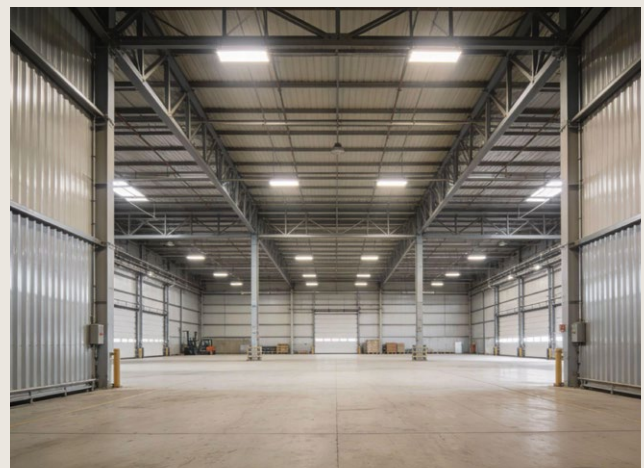
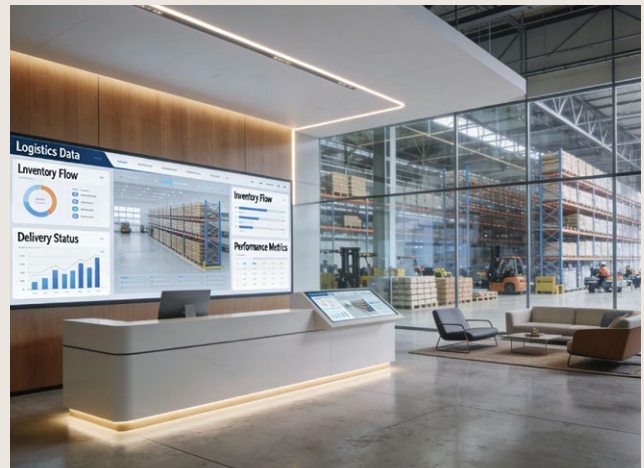
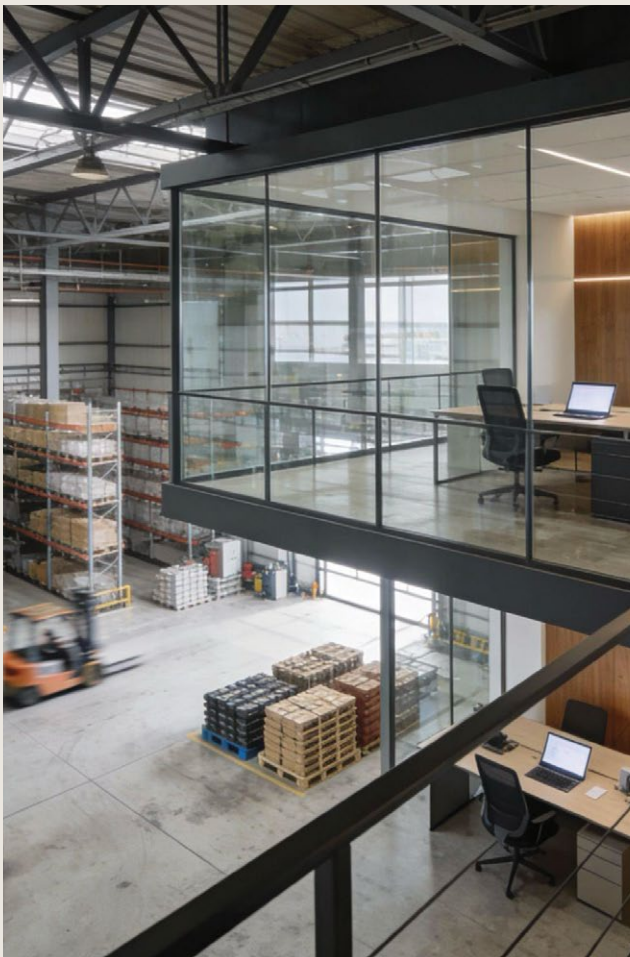

A NEW DEFINITION OF BUSINESS SPACE: MULTI-FUNCTIONAL BUSINESS ASSET

TRANSCENDING THE LIMITS OF TRADITIONAL
REAL ESTATE INTO A MULTI-FUNCTIONAL SPACE
THAT ANSWERS EVERY DIMENSION OF LIFE
AND BUSINESS.



SHOWROOM

Elevate brand image with a luxuriously designed reception area.



SMART WAREHOUSE

Standardized storage space with loading bays designed for real business.



CREATIVE OFFICE

High-ceilinged DOUBLE VOLUME space, adaptable into a studio or an inspiring office.



RESIDENCE

Private space for a superior relaxation experience.



EXCLUSIVE OWNERSHIP MODELS

2 MODES OF OWNERSHIP
TO MEET DIFFERENT BUSINESS VISIONS:



1 BUILT TO ORDER

Freedom of design... reflecting your business identity

Freedom of design... reflecting your business identity with a professional architect team providing close consultation.



Design buildings freely according to your requirements.



Unique designs that reflect your identity.



Flexible space utilization adjustments.

2 BUILT TO SUIT

End-to-end project development... for maximum efficiency

End-to-end project development... for maximum efficiency, from design and construction to handover.



Ready-to-deliver project development.



Space design tailored to your business needs.



Immediate business commencement.





3 STRATEGIC LOCATIONS CONNECTING MAJOR LOGISTICS NETWORKS

1. RAYONG

Located in the Industrial Estate Market Zone, the business powerhouse of the EEC.

2. LAEM CHABANG

A strategic Gateway location to Laem Chabang Port, close to premium industrial seaports.

3. BANGNA-THEPARAK

The “Core Industrial Zone of Thailand,” near Suvarnabhumi Airport and major logistics networks.



RAYONG



LAEM CHABANG



BANGNA-THEPARAK

RAYONG



RAYONG

4 UNIT

LAND
304 - 478
SQ.WA

USABLE AREA
539
SQ.M.

PRICE
43 - 64
MB.*

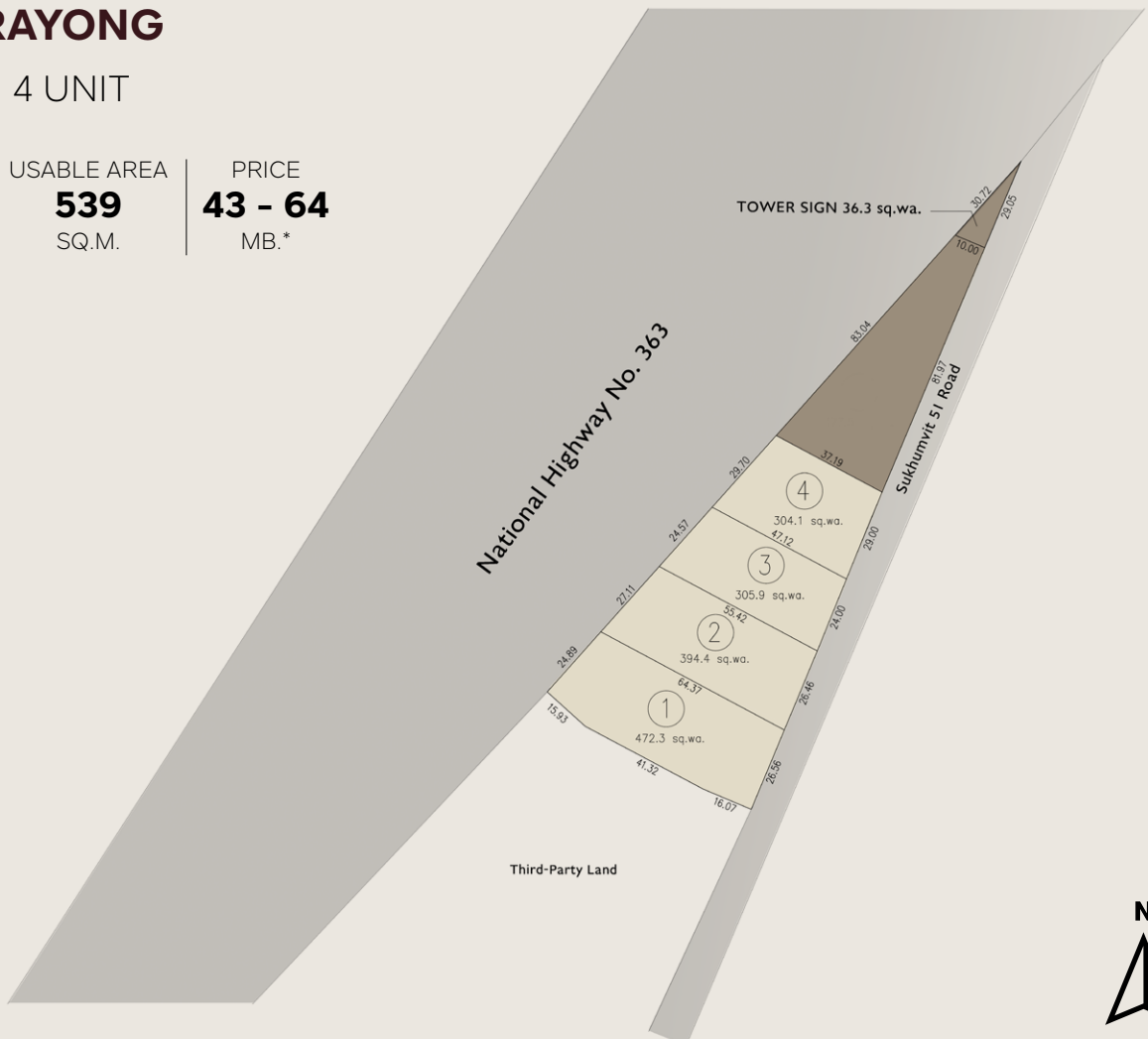

*T&Cs APPLY/This image is for advertising purposes only

LAEM CHABANG

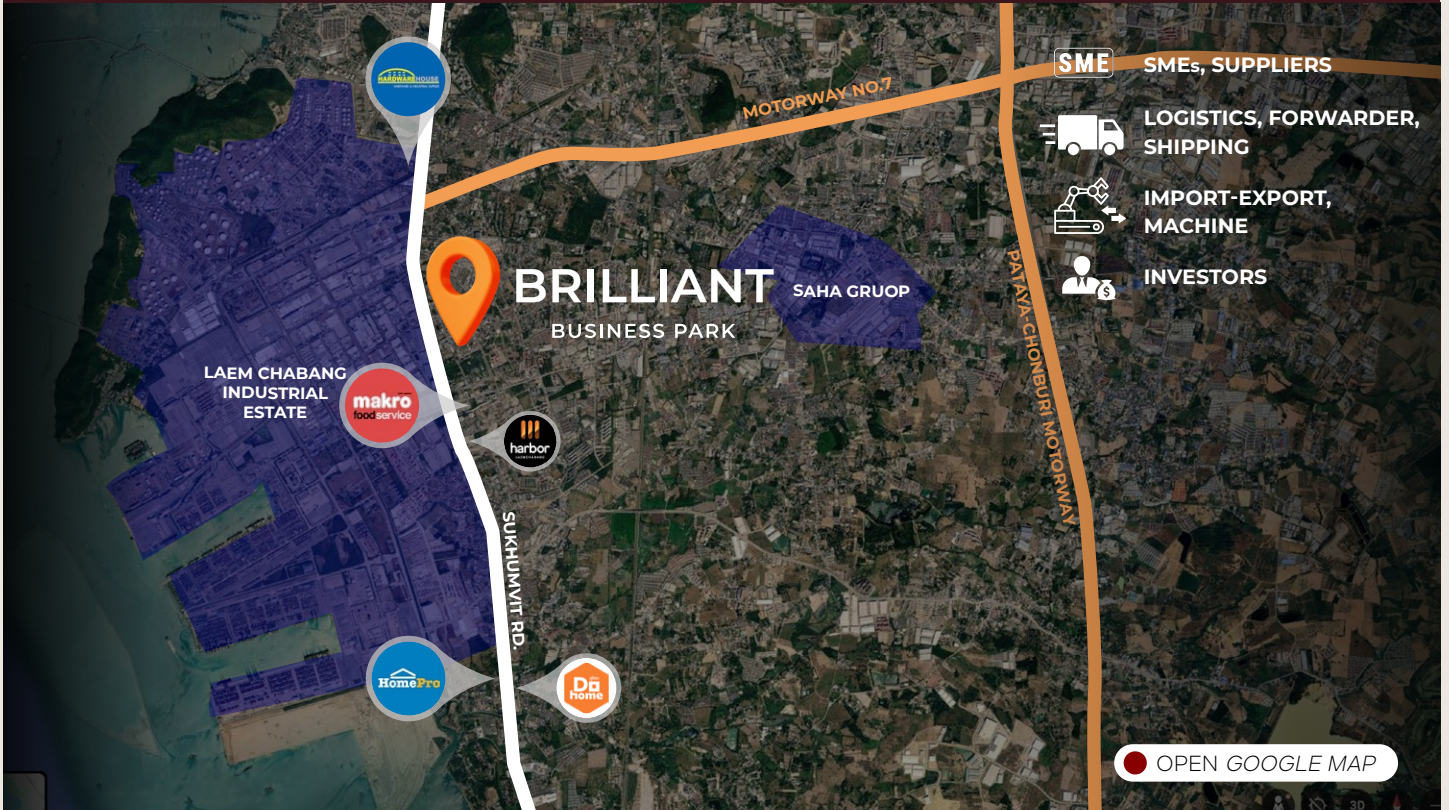

LAEM CHABANG

8 UNIT

LAND	USABLE AREA	PRICE
402 - 542	710 - 782	68 - 92
SQ.WA	SQ.M.	MB.*

*T&Cs APPLY/This image is for advertising purposes only

BANGNA - THEPARAK

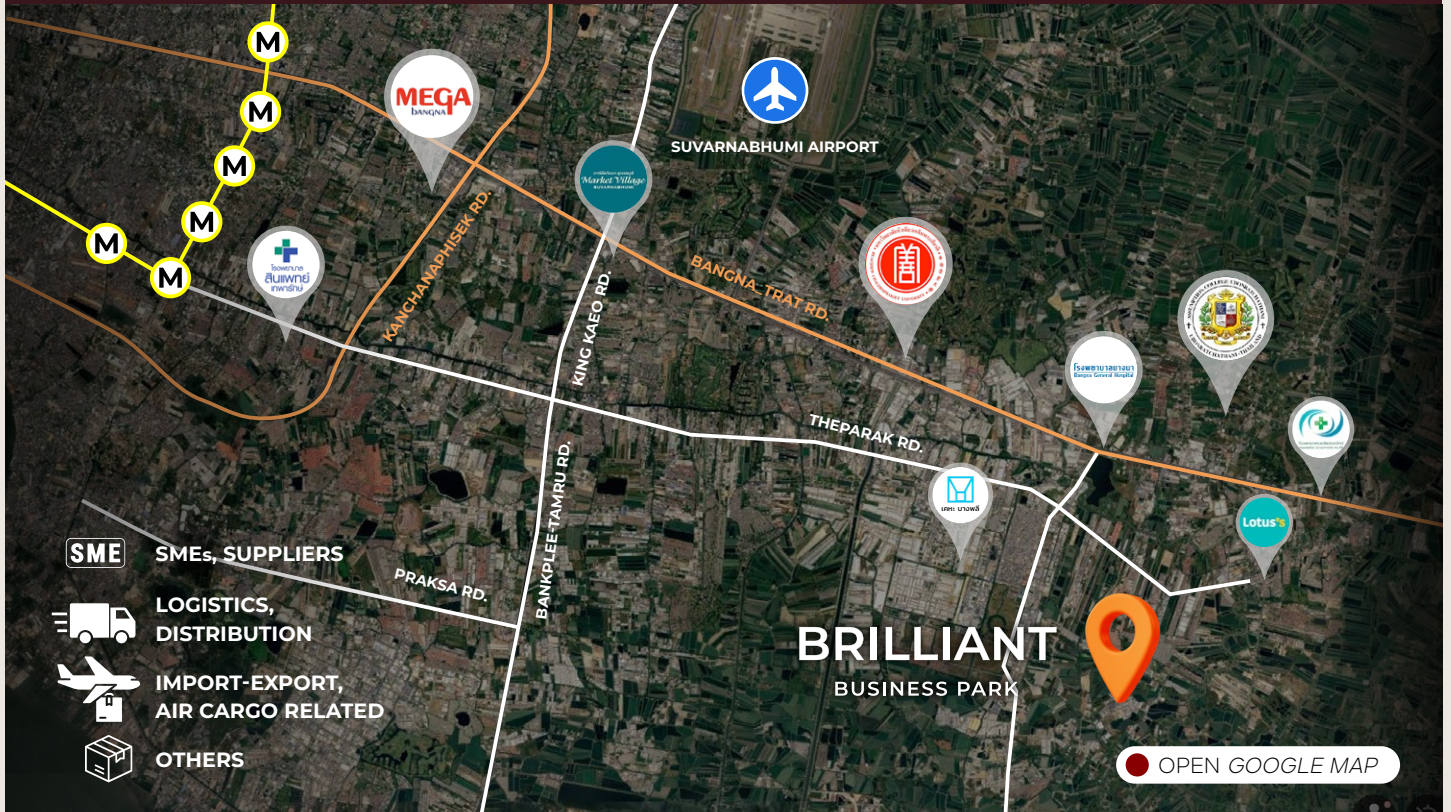

BANGNA - THEPARAK

7 UNIT

LAND	USABLE AREA	PRICE
389 - 1,110 SQ.WA	770 - 1,800 SQ.M.	42 - 113 MB.*

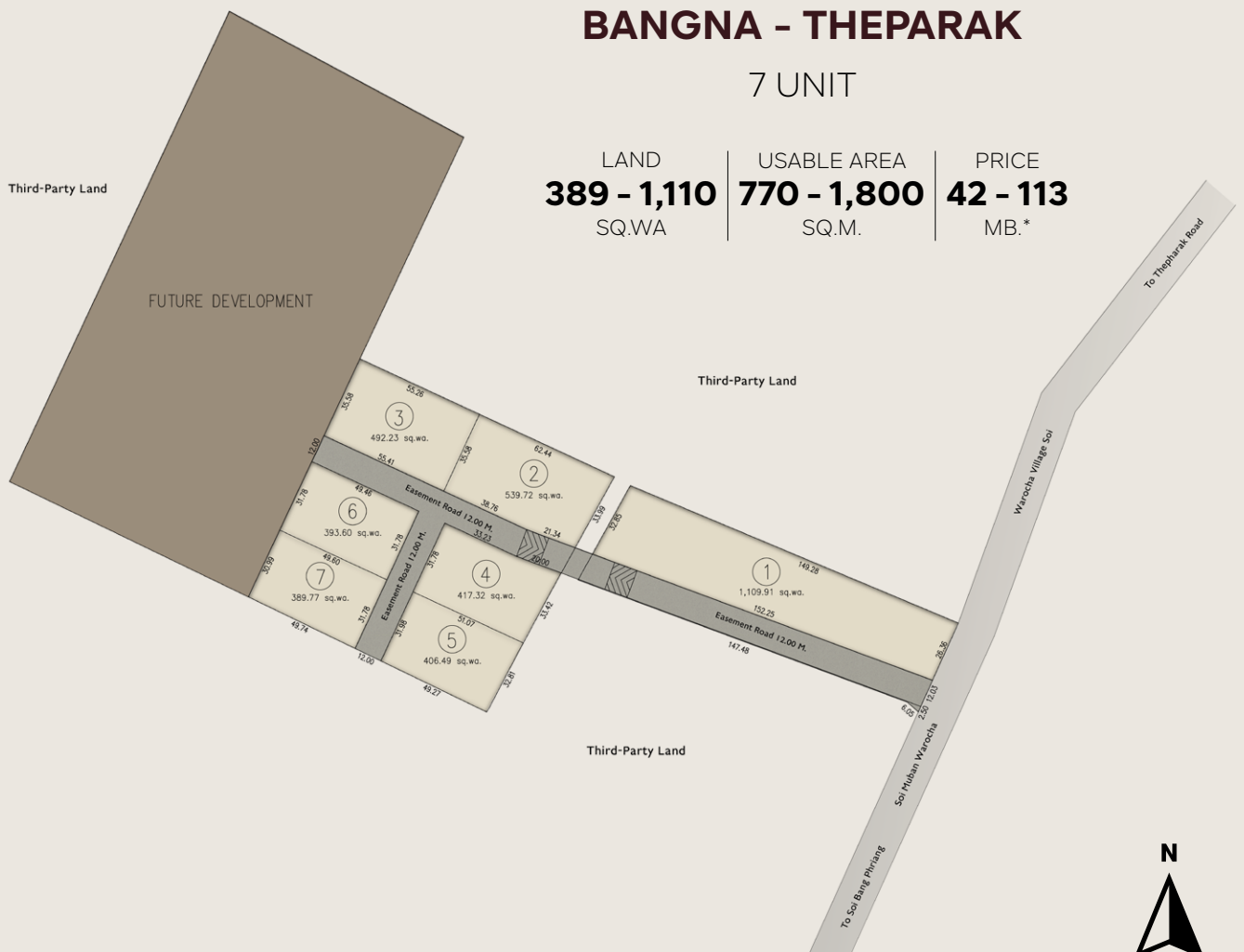

*T&Cs APPLY/This image is for advertising purposes only

BRILLIANT SMART

HOME OFFICE TYPE A USABLE AREA 284 SQ.M. (WAREHOUSE USABLE AREA 255-426 SQ.M.)



SPECIFICATION

- MULTI-PURPOSE SPACE 100 SQ.M.
- OFFICE 84 SQ.M.
- LIVING SPACE 100 SQ.M.
- 5 PARKING SPACES
- 7 TOILETS



1ST FLOOR PLAN

MULTI-PURPOSE AND WAREHOUSE, MALE/FEMALE TOILETS



2ND FLOOR PLAN

OFFICE : SPACE FOR 5 DESKS, MALE/FEMALE TOILETS, MEETING AREA, PANTRY



3RD FLOOR PLAN

LIVING SPACE : 2 BEDROOMS, 2 BATHROOMS, PANTRY, LIVING AREA

BRILLIANT SIGNATURE

HOME OFFICE TYPE B USABLE AREA 442 SQ.M. (WAREHOUSE USABLE AREA 328-475 SQ.M.)

SPECIFICATION

- MULTI-PURPOSE SPACE 178 SQ.M.
- OFFICE 132 SQ.M.
- LIVING SPACE 132 SQ.M.
- 9 PARKING SPACES
- 7 TOILETS

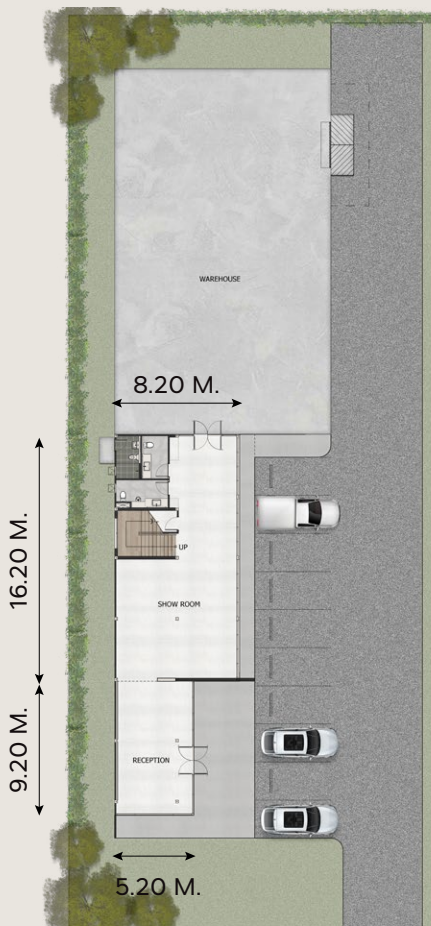

1ST FLOOR PLAN

MULTI-PURPOSE AND WAREHOUSE, MALE/FEMALE TOILETS

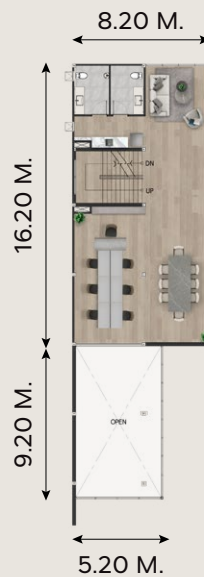

2ND FLOOR PLAN

OFFICE : SPACE FOR 7 DESKS, LIVING & MEETING AREA, MALE/FEMALE TOILETS, PANTRY



3RD FLOOR PLAN

LIVING SPACE : DOUBLE MASTER BEDROOM, 2 BATHROOMS, PANTRY, LIVING & DINING AREA

START YOUR **BRILLIANT**
SUCCESS TODAY

FOR INFORMATION



LINE OFFICIAL



WEBSITE